

**RIDI** .....  
AC 230-240V/50-60Hz

**VI**

schwarz  
black

blau  
blue

10

11

A	Ø	A	A	mm <sup>2</sup>	A
	0,8-1,2	9	sol.	0,5-1,0	9
max. ø1,8mm	1,3-1,8	12	0,5-2,5mm <sup>2</sup>	1,5-2,5	12

Typ	
MAXI-P1-GTR 426-42 EVG	4xTC-DEL/TEL 26-42W
MAXI-P1-GTR 326-42 EVG	3xTC-DEL/TEL 26-42W
MAXI-P1-GTR 140 EVG	1xT16-R 40W
MAXI-P1-GTR 155 EVG	1xT16-R 55W
MAXI-P1-GTR 160 EVG	1xT16-R 60W
MAXI-P1-GTR 140+60 EVG	1xT16-R 40W+1xT16-R 60W
MAXI-P1-GTR 3x40 E27	3xA60 40W
MAXI-P1-GTR 4x40 E27	4xA60 40W

**! MAXI-LSR/LSQ 60x...**

Typ	
MAXI-D-GTR 426-42 EVG	4xTC-TEL 26W
MAXI-D-GTR 326-42 EVG	3xTC-TEL 26W

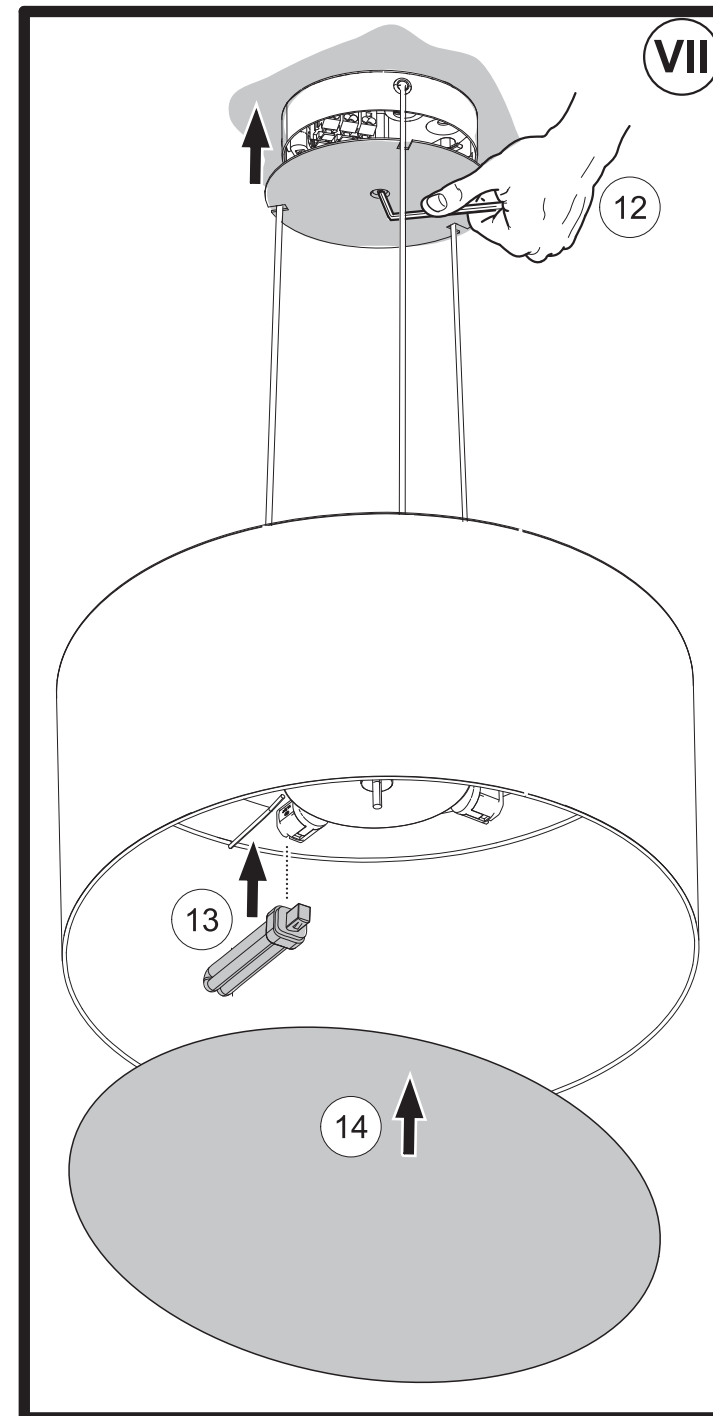

**RIDI**

**MAXI-P1-GTR**  
**Montageanleitung**

**RIDI Leuchten GmbH**  
Hauptstrasse 31 - 33  
D-72417Jungingen  
Tel.:07477/872-0  
Fax.:07477/872-48  
eMail:info@ridi.de  
Internet:www.ridi.de

26/15

MON6041

**I**

**D** Für die Installation und für den Betrieb der Leuchten sind die nationalen Sicherheitsvorschriften zu beachten.

**F** Pour l'installation et le fonctionnement des luminaires il est impératif de respecter les normes nationales de sécurité en vigueur.

**GB** Please note national safety instructions for installation and operation of this luminaire.

**PL** W celu prawidłowej instalacji i poprawnego działania oprawy należy przestrzegać krajowych przepisów bezpieczeństwa.

**E** Para la instalación y la puesta en funcionamiento de las luminarias deben observarse las normas nacionales de seguridad.



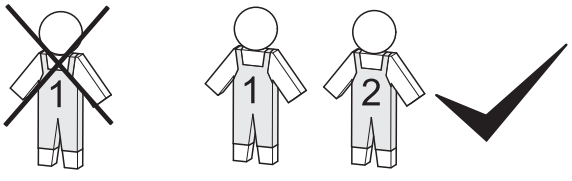

---



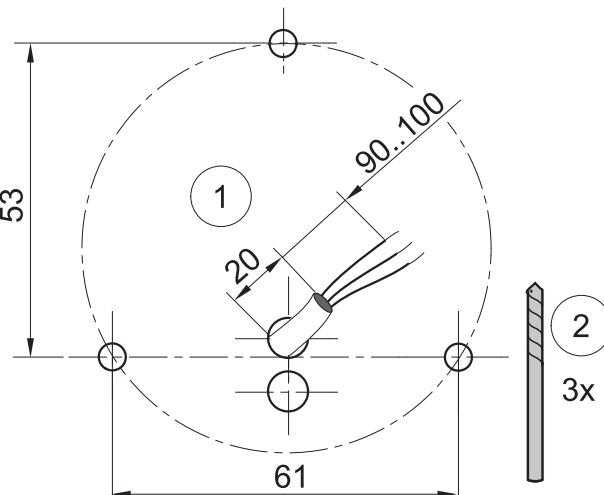

---

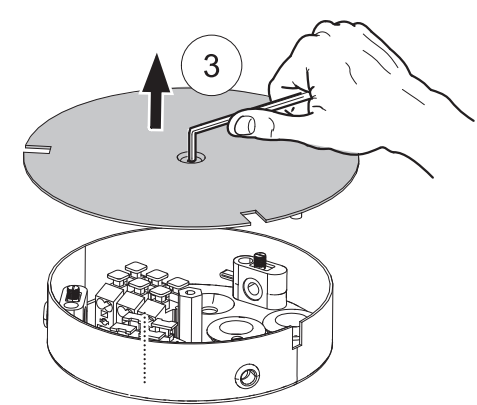

**II**

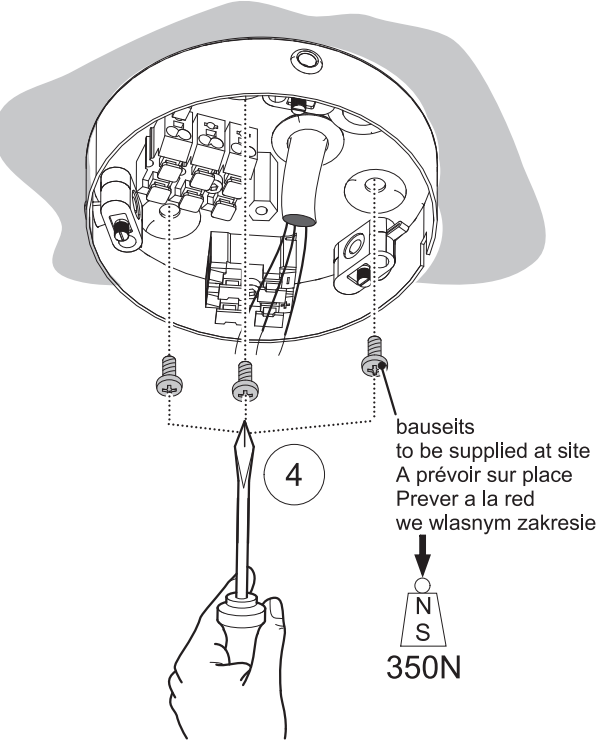

---



bauseits  
to be supplied at site  
A prévoir sur place  
Prever a la red  
we własnym zakresie

350N

**III**

	MAXI-LSQ 60x...		<b>III</b>
	MAXI-LSQ 75x...		
	MAXI-LSQ 100x...		
	MAXI-LSR 60x...		<b>III</b>
	MAXI-LSR 75x...		
	MAXI-LSR 100x...		

Bef. satz  
MAXI-LSR...  
Montageanleitung

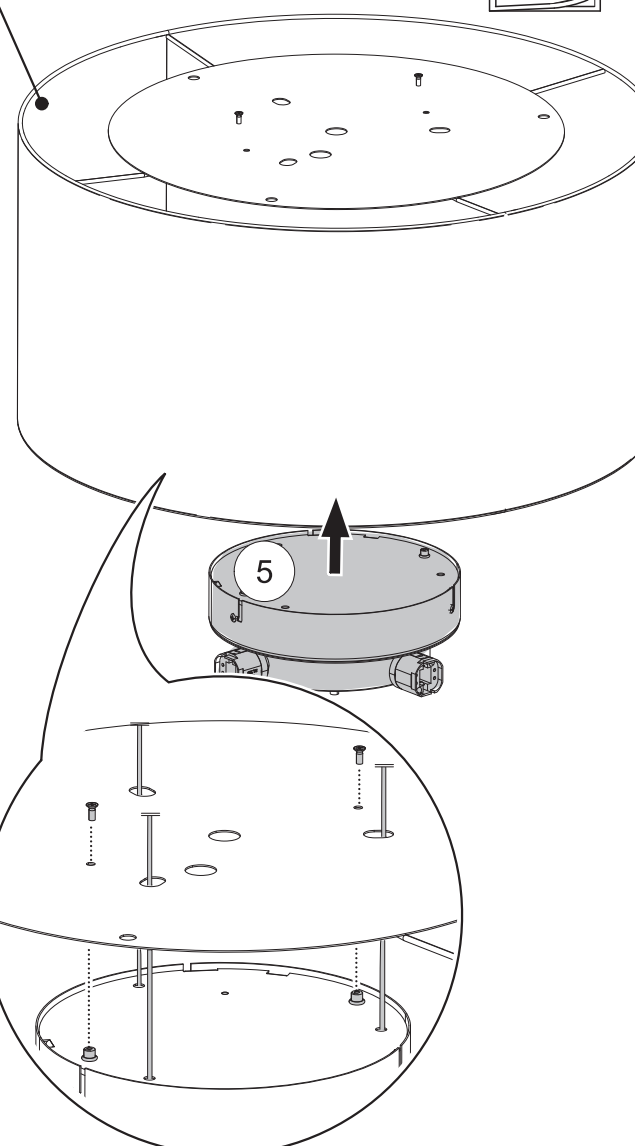

**IV**

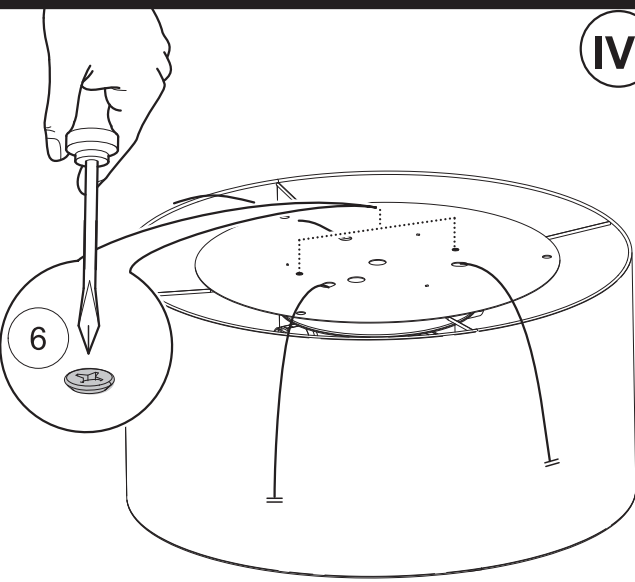

---

MAXI-LSQ-ISA 60	
MAXI-LSQ-ISA 75	
MAXI-LSQ-ISA 100	
MAXI-LSR-ISA 60	
MAXI-LSR-ISA 75	
MAXI-LSR-ISA 100	

